

PBV® 3-Way Multi-Port Series 5338/6338 Engineering Data

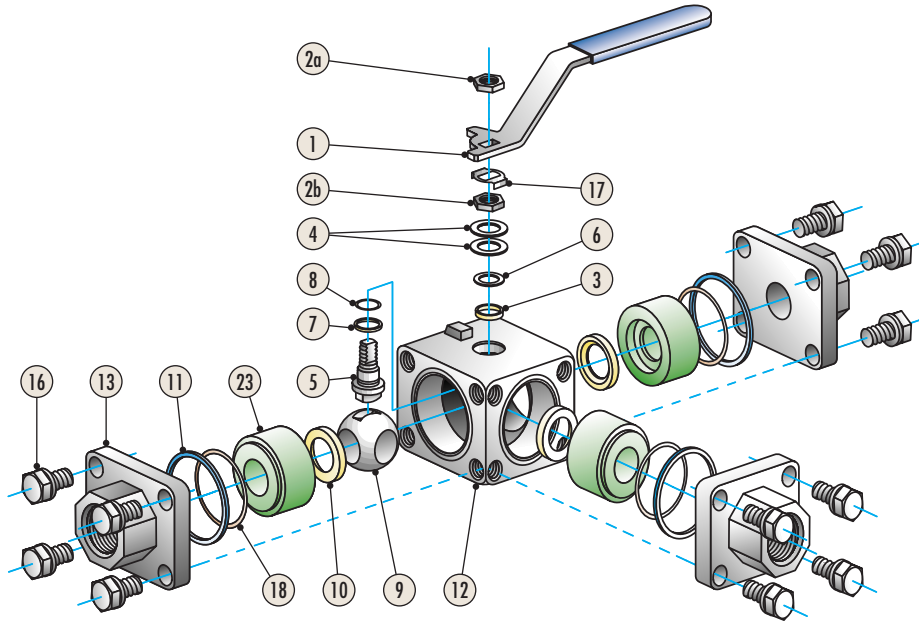

Parts & Materials

Part No.	Qty.	Description	Material, Series 5338/6338	
			A105/F316	F316/F316
1	1	Handle	C.S. Galvanized Plastic Cover	C.S. Galvanized Plastic Cover
2	1+1	Nut	C.S. Cadmium Plated	A194 Gr.8
3	1	Packing Ring	Graphite	Graphite
4	2	Spring Washer	S.S. 302	S.S. 302
5	1	Antistatic Stem	S.S. 316	S.S. 316
6	1	Gland Follower	ASTM A182 F316L	ASTM A182 F316L
7	1	Thrust Washer	Reinforced PTFE	Reinforced PTFE
8	1	Stem O-Ring	Viton®	Viton®
9	1	Ball	ASTM A182 F316	ASTM A182 F316
10	4	Seats	Reinforced PTFE	Reinforced PTFE
11	3	Body Seal	Graphite	Graphite
12	1	Body	A105N	ASTM A182 F316
13	4	End Connections	A105N	ASTM A182 F316L
14	1	Stop-Pin	Carbon Steel	Stainless Steel
16	12	Bolt	ASTM A193 B7M	ASTM A193 B8M
17	1	Stop Washer	S.S. ASTM A182 F316	S.S. ASTM A182 F316
18	3	Body Seal	Viton®	Viton®
23	3	Seat Retainer	A105N	A182 F316

Pressure Temperature – M Seat

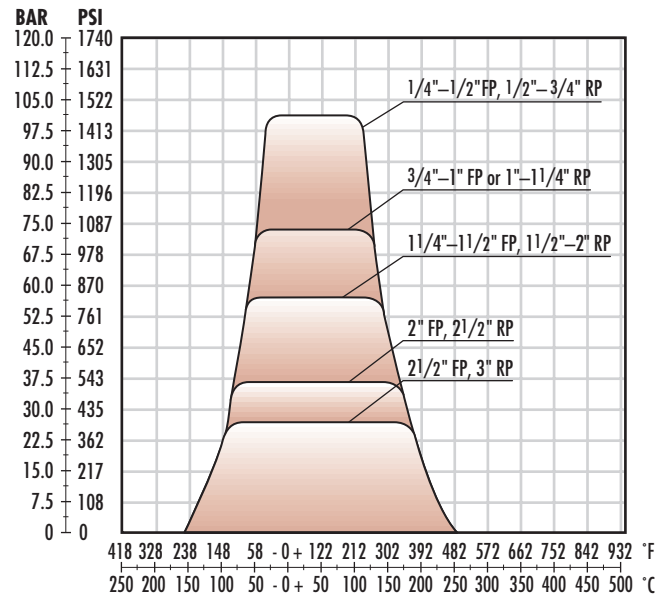

Flow Coefficient (Cv)

Size (in.) Reduced Port								
—	1/2	3/4	1	1 1/4	1 1/2	2	2 1/2	3
—	5.6	10.5	24.0	40.0	60.0	87.5	175.0	223.0

Size (in.) Full Port							
—	1/2	3/4	1	1 1/4	1 1/2	2	2 1/2
—	—	10.5	24.0	40.0	60.0	87.5	175.0

Cv values apply to the port configurations shown below:



*Flow Data: Flow rates were determined for ball valves in fully open position and a water temperature of 60°F (15°C). Cv value is the full capacity flow rate through the ball valve in gallons/min. of water at 60°F with a pressure of one PSI.
Note: When T-Port works like the 2-way valves, use Cv values for PBV 5331/6331 and deduct 50%.

Soft Parts Repair Kit

Part No.	Qty.	Part Name	Material
3	1	Packing Ring	Graphite
7	1	Thrust Washer	RPTFE
8	1	Stem O-Ring	Viton®
10	3	Seats	Devlon® V
11	3	Body Seals	RTFE
18	3	Body Seals	Graphite