

Parts and Materials for Stem O-Ring Design Valves

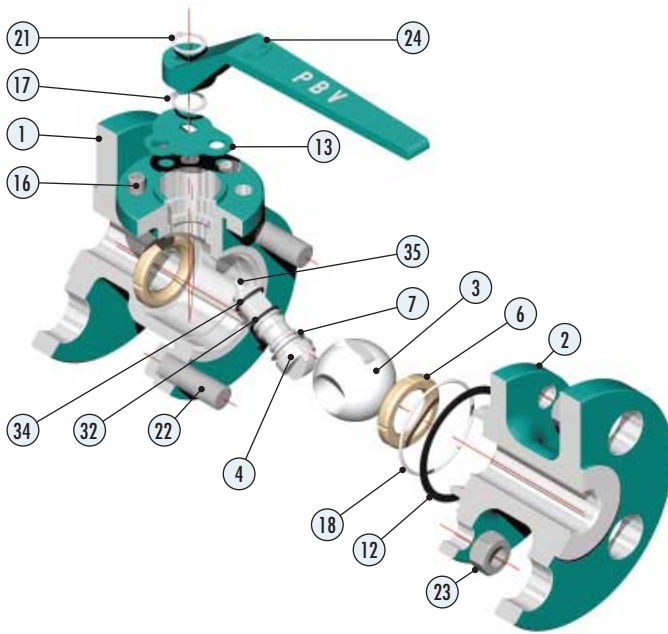

Series 6500, 1", Class 150 & 300

Standard Material Configuration For Oil & Gas Service - API 6D

Item No.	Description	Material		
		WCB	LCC	CF8M
1	Body	WCB	LCC	CF8M
2	Cap	WCB	LCC	CF8M
3	Ball	ASTM A351 CF8M		
4	Stem	ASTM A276 316 (SS)		
6	Ball Seat	TFMC		
7	Stem Bearing	G/F PTFE		
12	Body Gasket	Graphite		
13	Stop Plate/Lock Device	Stainless Steel		
16	Stop	Stainless Steel		
17	Snap Ring	Stainless Steel		
18	Body O-Ring	Viton® GF		
21	Snap Ring	Stainless Steel		
22	Stud	B7M	L7M	B8
23	Nut	2HM	7M	8
24	Handle	Ductile Iron		
26	ID Tag (not shown)	Stainless Steel		
27	ID Drive Screw (not shown)	Stainless Steel		
32	Primary O-Ring, Stem	Viton® GF		
34	Weather Seal	Viton® GF		
35	Grease Fitting	Stainless Steel		

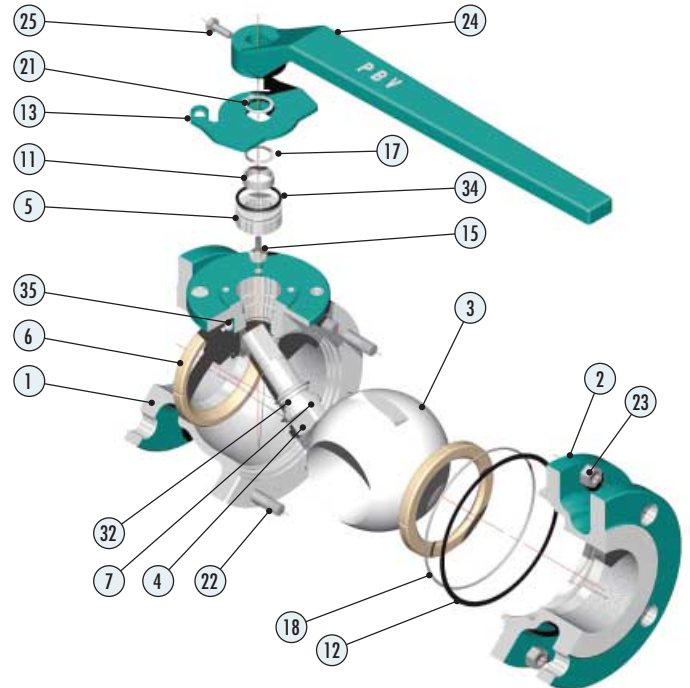

Series 6500, 1 1/2"- 6", Class 150 & 300, 1 1/2"- 4", Class 600
Series 4500, 1 1/2"- 6", Class 150, 300 & 600

Standard Material Configuration For Oil & Gas Service - API 6D

Item No.	Description	Material		
		WCB	LCC	CF8M
1	Body	WCB	LCC	CF8M
2	Cap	WCB	LCC	CF8M
3	Ball	ASTM A351 CF8M		
4	Stem	ASTM A276 316		
5	Gland	Stainless Steel		
6	Ball Seat	TFM/TFMC (Note 3)		
7	Stem Bearing	G/F PTFE		
11	Gland Bearing	G/F PTFE		
12	Body Gasket	Graphite		
13	Stop Plate/Lock Device	Stainless Steel		
15	Lock Pin	Stainless Steel		
16	Stop (not shown)	Stainless Steel		
17	Snap Ring	Stainless Steel		
18	Body O-Ring	Viton® GF		
19	Lock Washer (not shown)	Stainless Steel		
21	Snap Ring	Stainless Steel		
22	Stud	B7M	L7M	B8
23	Nut	2HM	7M	8
24	Handle	Ductile Iron		
25	Handle Screw	Carbon Steel		
26	ID Tag (not shown)	Stainless Steel		
27	ID Drive Screw (not shown)	Stainless Steel		
32	Primary O-Ring, Stem	Viton® GF		
34	Weather Seal	Viton® GF		
35	Grease Fitting	Stainless Steel		

Note: 1. 8" & 10" use bar type handle.

2. Gear is optional.

3. Nylon: Series 6500, 3" & 4", Class 600, Series 4500, 4" & 6", Class 600