

Series 5700/6700 ■ 3"-4" Class 300 ■ 2"-4" Class 600, 900, 1500 and 2500

| No. | Description             | Material                      | Spares |
|-----|-------------------------|-------------------------------|--------|
| 1   | Body                    | A105/A350 LF2                 |        |
| 2   | Closure/Flanged End     | A105/A350 LF2                 |        |
| 4   | Ball                    | 316SS                         |        |
| 5   | Stem                    | 316SS                         |        |
| 6   | Seat Ring Sub Assembly  | 316SS- G/PTFE<br>316SS- Nylon | S      |
| 9   | Trunnion                | 4130 ENP                      |        |
| 10  | Gland                   | 4130 ENP                      |        |
| 12  | Adapter Plate           | A36                           |        |
| 20  | Stem Key                | Carbon Steel                  |        |
| 25  | Stem Thrust Washer      | Graphite                      | S      |
| 28  | Ball Bearing            | DU Dry Bearing                |        |
| 31  | Seat/Stem Spring        | X-750                         |        |
| 32  | Body O-ring             | Viton®                        | S      |
| 33  | Seat O-ring             | Viton®                        | S      |
| 34  | Stem O-ring             | Viton®                        | S      |
| 35  | Gland & Trunnion O-ring | Viton®                        | S      |
| 39  | Body Stud               | A193 B7M                      |        |
| 40  | Body Nut                | A194 2HM                      |        |
| 43  | Gland Cap Screw         | A574 Modified                 |        |
| 44  | Adapter Plate Cap Screw | A574 Modified                 |        |
| 45  | Trunnion Cap Screw      | A574 Modified                 |        |
| 46  | Stem Key Cap Screw      | Carbon Steel                  |        |
| 49  | Stem Grease Fitting     | Carbon Steel                  |        |
| 50  | Body Grease Fitting     | Carbon Steel                  |        |
| 51  | Check Valve             | Stainless Steel               |        |
| 54  | Drain Valve             | Carbon Steel                  |        |
| 60  | Handle                  | Ductile Iron                  |        |
| 62  | Indicator Screw         | Carbon Steel                  |        |
| 63  | Retainer Washer         | Carbon Steel                  |        |
| 64  | Name Plate              | Stainless Steel               |        |
| 65  | Drive Screw             | Stainless Steel               |        |
| 67  | Handle Adapter          | Carbon Steel                  |        |
| 69  | Lock Screw              | Carbon Steel                  |        |
| 70  | Body Gasket             | Graphite                      | S      |
| 71  | Gland & Trunnion Gasket | Graphite                      | S      |
| 72  | Stem Packing            | Graphite                      | S      |

NOTE: Materials listed are typical for stainless steel trim valves. Stronger materials may be used to satisfy design requirements.

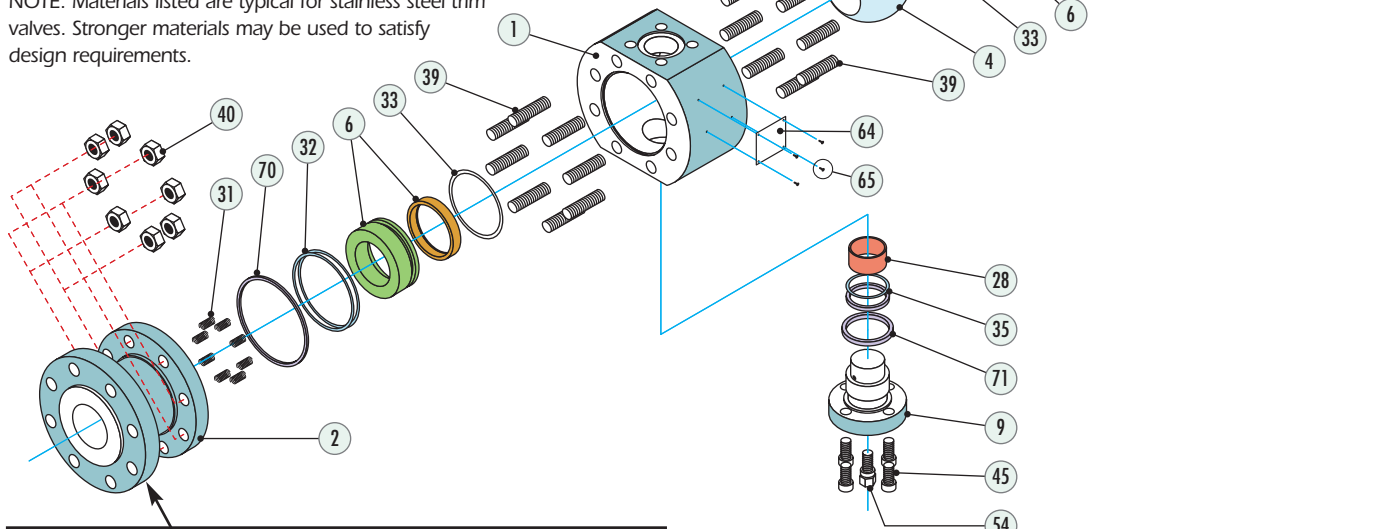

**For Reference Only**

**3"-4" Class 300**

API flange drilled and tapped to maintain API 6D face to face dimension.

3"x3" Class 300 ■ Use 3/4"-10 UNC x 3.38" stud.

4"x4" Class 300 ■ Use 3/4"-10 UNC x 3.5" stud.

These items may also be supplied with a locking worm gear operator. Assemblies are illustrations only. Parts may vary according to design.

**Series 5700/6700 ■ 2"FP-6" RP ■ Class 150, 300 and 600**

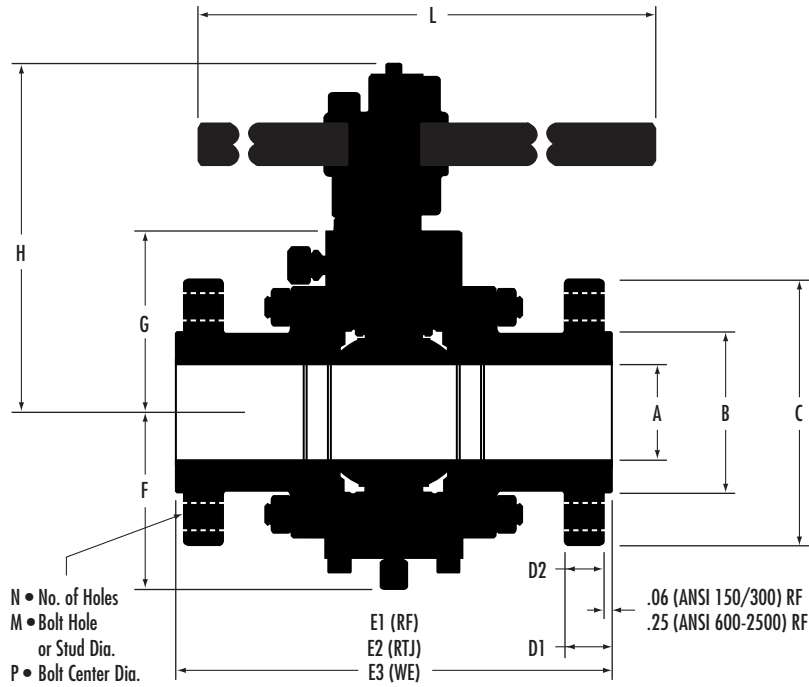

**Class 150 6"RP (in.)**

| Size | A         | B    | C     | D1   | E1-RF | E2-RTJ | E3-WE | F    | G    | H     | N | M    | P    | L  |
|------|-----------|------|-------|------|-------|--------|-------|------|------|-------|---|------|------|----|
| 6x4  | 6.00x4.00 | 8.50 | 11.00 | 1.00 | 15.50 | 16.00  | 18.00 | 7.30 | 7.35 | 12.93 | 8 | 0.88 | 9.50 | 48 |

NOTES: Sizes 6"x6" and larger are gear operated. Dimension "F" includes drain plug and support brackets.

**Class 300 3"RP-6"RP (in.)**

| Size | A         | B    | C     | D1   | E1-RF | E2-RTJ | E3-WE | F    | G    | H     | N  | M         | P     | L  |
|------|-----------|------|-------|------|-------|--------|-------|------|------|-------|----|-----------|-------|----|
| 3x2  | 3.00x2.00 | 5.00 | 8.25  | 1.12 | 11.12 | 11.75  | 11.12 | 4.89 | 4.87 | 9.55  | 8  | 0.88      | 6.62  | 30 |
| 3x3  | 3.00x3.00 | 5.00 | 8.25  | 1.12 | 11.12 | 11.75  | 11.12 | 5.87 | 5.94 | 10.92 | 8  | 3/4-10UNC | 6.62  | 30 |
| 4x3  | 4.00x3.00 | 6.19 | 10.00 | 1.25 | 12.00 | 12.62  | 12.00 | 5.87 | 5.94 | 10.92 | 8  | 0.88      | 7.88  | 30 |
| 4x4  | 4.00x4.00 | 6.19 | 10.00 | 1.25 | 12.00 | 12.62  | 12.00 | 7.30 | 7.35 | 12.93 | 8  | 3/4-10UNC | 7.88  | 48 |
| 6x4  | 6.00x4.00 | 8.50 | 12.50 | 1.44 | 15.88 | 16.50  | 18.00 | 7.30 | 7.35 | 12.93 | 12 | 0.88      | 10.62 | 48 |

NOTES: Sizes 6"x6" and larger are gear operated. Dimension "F" includes drain plug and support brackets.

**Class 600 2"FP-6"RP (in.)**

| Size | A         | B    | C     | D2   | E1-RF | E2-RTJ | E3-WE | F    | G    | H     | N  | M    | P     | L  |
|------|-----------|------|-------|------|-------|--------|-------|------|------|-------|----|------|-------|----|
| 2x2  | 2.00x2.00 | 3.62 | 6.50  | 1.00 | 11.50 | 11.62  | 11.50 | 4.89 | 4.87 | 9.55  | 8  | .75  | 5.00  | 30 |
| 3x2  | 3.00x2.00 | 5.00 | 8.25  | 1.25 | 14.00 | 14.12  | 14.00 | 4.89 | 4.87 | 9.55  | 8  | 0.88 | 6.62  | 30 |
| 3x3  | 3.00x3.00 | 5.00 | 8.25  | 1.25 | 14.00 | 14.12  | 14.00 | 5.87 | 5.94 | 10.92 | 8  | 0.88 | 6.62  | 30 |
| 4x3  | 4.00x3.00 | 6.19 | 10.75 | 1.50 | 17.00 | 17.12  | 17.00 | 5.87 | 5.94 | 10.92 | 8  | 1.00 | 8.50  | 30 |
| 4x4  | 4.00x4.00 | 6.19 | 10.75 | 1.50 | 17.00 | 17.12  | 17.00 | 7.30 | 7.35 | 12.93 | 8  | 1.00 | 8.50  | 48 |
| 6x4  | 6.00x4.00 | 8.50 | 14.00 | 1.88 | 22.00 | 22.12  | 22.00 | 7.30 | 7.35 | 12.93 | 12 | 1.12 | 11.50 | 48 |

NOTES: Sizes 6"x6" and larger are gear operated. Dimension "F" includes drain plug and support brackets.

Series 5700/6700 ■ 2"FP-6"RP ■ Class 900, 1500 and 2500

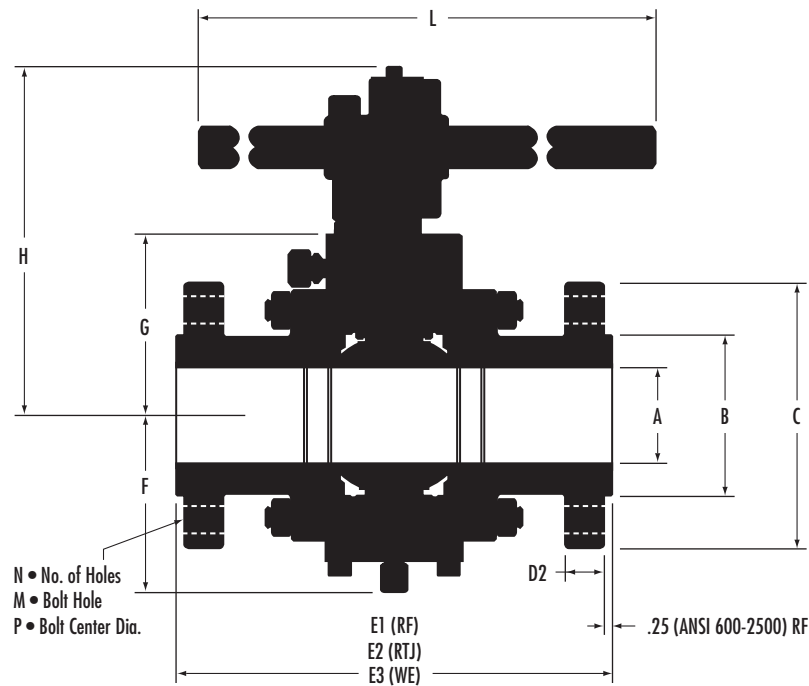

Class 900 2"FP-6"RP (in.)

| Size | A         | B    | C     | D2   | E1-RF | E2-RTJ | E3-WE | F    | G    | H     | N  | M    | P     | L  |
|------|-----------|------|-------|------|-------|--------|-------|------|------|-------|----|------|-------|----|
| 2x2  | 2.00x2.00 | 3.62 | 8.50  | 1.50 | 14.50 | 14.62  | 14.50 | 4.89 | 4.87 | 9.55  | 8  | 1.00 | 6.50  | 30 |
| 3x2  | 3.00x2.00 | 5.00 | 9.50  | 1.50 | 15.00 | 15.12  | 15.00 | 4.89 | 4.87 | 9.55  | 8  | 1.00 | 7.50  | 30 |
| 3x3  | 3.00x3.00 | 5.00 | 9.50  | 1.50 | 15.00 | 15.12  | 15.00 | 5.87 | 5.94 | 10.92 | 8  | 1.00 | 7.50  | 30 |
| 4x3  | 4.00x3.00 | 6.19 | 11.50 | 1.75 | 18.00 | 18.12  | 18.00 | 5.87 | 5.94 | 10.92 | 8  | 1.25 | 9.25  | 30 |
| 4x4  | 4.00x4.00 | 6.19 | 11.50 | 1.75 | 18.00 | 18.12  | 18.00 | 7.30 | 7.35 | 12.93 | 8  | 1.25 | 9.25  | 48 |
| 6x4  | 6.00x4.00 | 8.50 | 15.00 | 2.19 | 24.00 | 24.12  | 24.00 | 7.30 | 7.35 | 12.93 | 12 | 1.25 | 12.50 | 48 |

NOTES: Sizes 6"x6" and larger are gear operated. Dimension "F" includes drain plug and support brackets.

Class 1500 2"FP-6"RP (in.)

| Size | A         | B    | C     | D2   | E1-RF | E2-RTJ | E3-WE | F    | G    | H     | N  | M    | P     | L  |
|------|-----------|------|-------|------|-------|--------|-------|------|------|-------|----|------|-------|----|
| 2x2  | 2.00x2.00 | 3.62 | 8.50  | 1.50 | 14.50 | 14.62  | 14.50 | 5.32 | 5.47 | 10.30 | 8  | 1.00 | 6.50  | 30 |
| 3x2  | 3.00x2.00 | 5.00 | 10.50 | 1.88 | 18.50 | 18.62  | 18.50 | 5.32 | 5.47 | 10.30 | 8  | 1.25 | 8.00  | 30 |
| 3x3  | 3.00x3.00 | 5.00 | 10.50 | 1.88 | 18.50 | 18.62  | 18.50 | 6.89 | 6.42 | 11.60 | 8  | 1.25 | 8.00  | 30 |
| 4x3  | 4.00x3.00 | 6.19 | 12.25 | 2.12 | 21.50 | 21.62  | 21.50 | 6.89 | 6.42 | 11.60 | 8  | 1.38 | 9.50  | 30 |
| 4x4  | 4.00x4.00 | 6.19 | 12.25 | 2.12 | 21.50 | 21.62  | 21.50 | 8.14 | 7.88 | 13.75 | 8  | 1.38 | 9.50  | 48 |
| 6x4  | 5.75x4.00 | 8.50 | 15.50 | 3.25 | 27.75 | 28.00  | 27.75 | 8.14 | 7.88 | 13.75 | 12 | 1.50 | 12.50 | 48 |

NOTES: Sizes 6"x6" and larger are gear operated. Dimension "F" includes drain plug and support brackets.

Class 2500 2"FP-6"RP (in.)

| Size | A         | B    | C     | D2   | E1-RF | E2-RTJ | E3-WE | F    | G     | H     | N | M    | P     | L  |
|------|-----------|------|-------|------|-------|--------|-------|------|-------|-------|---|------|-------|----|
| 2x2  | 1.75x1.75 | 3.62 | 9.25  | 2.00 | 17.75 | 17.87  | 17.75 | 6.39 | 7.25  | 13.19 | 8 | 1.12 | 6.75  | 30 |
| 3x2  | 2.50x1.75 | 5.00 | 12.00 | 2.62 | 22.75 | 23.00  | 22.75 | 6.39 | 7.25  | 13.19 | 8 | 1.38 | 9.00  | 30 |
| 3x3  | 2.50x2.50 | 5.00 | 12.00 | 2.62 | 22.75 | 23.00  | 22.75 | 8.20 | 8.42  | 14.68 | 8 | 1.38 | 9.00  | 30 |
| 4x3  | 3.50x2.50 | 6.19 | 14.00 | 3.00 | 26.50 | 26.88  | 26.50 | 8.20 | 8.42  | 14.68 | 8 | 1.63 | 10.75 | 30 |
| 4x4  | 3.50x3.50 | 6.19 | 14.00 | 3.00 | 26.50 | 26.88  | 26.50 | 9.43 | 10.56 | 16.93 | 8 | 1.63 | 10.75 | 48 |
| 6x4  | 5.25x3.50 | 8.50 | 19.00 | 4.25 | 36.00 | 36.50  | 36.00 | 9.43 | 10.56 | 16.93 | 8 | 2.12 | 14.50 | 48 |

NOTES: Dimension "F" includes drain plug and support brackets.